

# WSU LANDSCAPE ARCHITECTURE

## Spring Semester Newsletter

### Spring Events

NW Faculty Exchange

LA Senior Capstone Review  
April 29

Student Portfolio Presentations  
April 30

**For more SDC news & events**  
[News & Events](#)

### Upcoming Events

WASLA Conference  
Meet and Greet in Spokane  
October 2021  
Details forthcoming

### School & Program Updates

#### **Ryan Smith, SDC Director**

Dear Landscape Architecture Community! The School of Design and Construction and the Landscape Architecture Program have successfully completed another semester – online – in a pandemic. The students amaze me with their resilience and commitment. Our faculty have persevered and provided excellent professional education at a time of uncertainty. Thank you for your continued support to the school and to the LA program.

I am enthused to announce a search for a new faculty member in the school with a focus on social and environment justice in the built environment. This new hire will strengthen our commitment to social justice in our curriculum, research, outreach, and culture. Fall 2021 classes are planned to be face-to-face on the Pullman campus. We look forward to the prospect of seeing you in person sometime soon. Onward!

#### **Jolie Kaytes, LA Program Head**

Palouse hellos! With great satisfaction, delight, and much relief we concluded the spring semester and 2020-21 academic year. Though online course delivery was hard, we remained utterly busy and many good things happened! Some highlights include:

- Juniors participated in a WASLA led online job shadow with Spokane-based firms. Thank you to all our hosts.
- A Pop-up Mentor program allowed students to get end of semester feedback from practitioners. Thank you mentors.
- Students formally established a [WSU Student Chapter of NAMLA](#) (National Association of Minority Landscape Architects). It is one of five student chapters in the US.
- The student led Community Design Team completed a master plan for the Thornton Murphy Community Garden in Spokane.
- Senior work on tiny houses was featured in [WSU Insider](#).
- Site Workshop, with added support from the Berger Partnership and GGN, established the [Endowed Scholarship for Diversity in Landscape Architecture](#) for the WSU and UW LA programs.

**Give today**

Landscape Architecture Excellence Fund

Landscape Architecture Course Development Fund

Ken Struckmeyer Student Scholarship Endowment

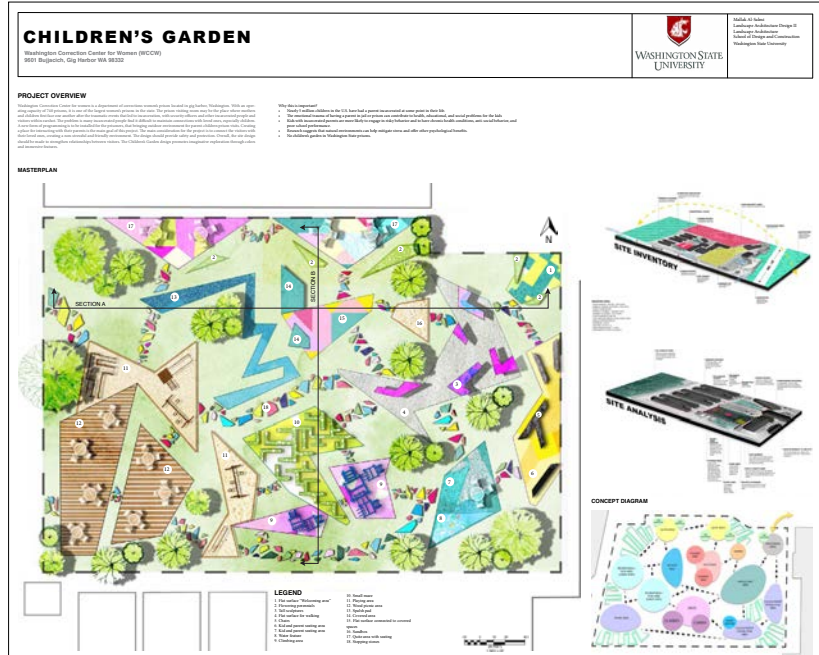

Detail from sophomore Mallak Al-Salmi’s final board

**Studio Highlights**

Sophomores developed master plans for a children’s garden at the Washington Corrections Center for Women, Gig Harbor, WA. The students researched issues relating to incarcerated parents and their children and then created plans for supportive, safe, and child-friendly spaces to be used during visits.

Juniors partnered with the Latah Environment, Agriculture and Fisheries (LEAF) Heritage Project to generate alternative design concepts for a 48-acre agricultural site in Spokane slated to become a gated development. Student work was informed by LEAF’s vision, regional ecologies, and the site’s complicated past.

Senior capstone work focused on the confluence of the Clearwater and Snake Rivers and the communities of Clarkston, Washington and Lewiston, Idaho. Students were challenged to develop projects that addressed the climate crisis via resilient and adaptive strategies, as well as considering possible urban planning implications of a Green New Deal.

We are grateful to our many guest reviewers this semester.

The LA Excellence Fund & LA Course Development Fund help support student activities. Thank you for your support!

### LA Faculty Fall 2020



Steve Austin  
Associate Professor



Jolie Kaytes  
Professor & Program Head



Kate Kraszewska  
Assistant Professor

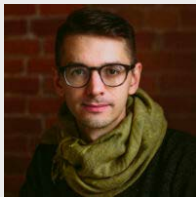

Alex Mann  
Instructor



Michael Sánchez  
Assistant Professor

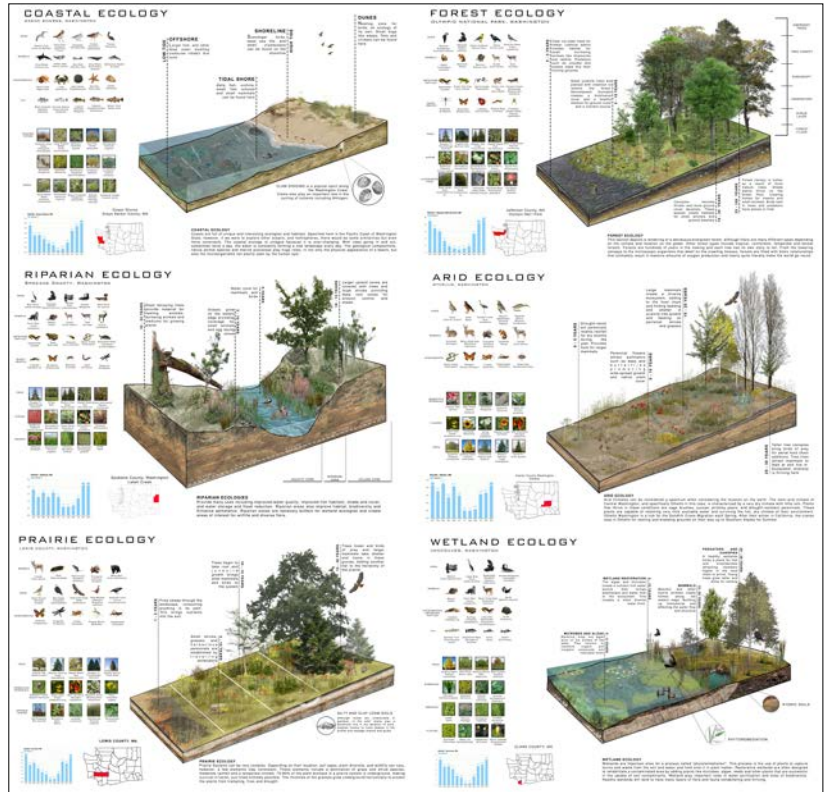

Ecoregion cross-sections, by LA junior, Julianna Mettler



Capstone vision, by senior, Jesus Gomez.

## LA Professional Advisory Board

**Craig Andersen**  
AHBL

**Jason Anderson**  
Design Two Four/Two Six

**Mark Brands**  
Site Workshop

**Katie Bang**  
Seattle Parks & Recreation

**Kerstin Dettrich**  
The Land Group

**Derrick Eberle**  
Bruce Dees & Associates

**Peg Staeheli**  
MIG | SvR

**Lucas Vannice**  
The Watershed Company

**Holly Williams**  
KPG Interdisciplinary Design



LA juniors received special permission for face-to-face activities for two design-build class projects. Pictured: Construction of a wheelchair accessible garden plot at Koppel Farm.

## LA Faculty Notes

Jolie Kaytes | Forthcoming talk “People, Place, Water & Story” at the Universities Council on Water Resources Annual Conference

Kate Kraszewska | Received two grants from the Washington Turfgrass Seed Commission to study turfgrass and stormwater. Learn more about Kate [here](#).

Alex Mann | Forthcoming essay, “Beautiful Ontology: Landscape Architecture in the Anthropocene,” in *Ground Up Journal*

## LA Professional Advisory Board Notes

The LA Professional Advisory Board (LAPAB) met via Zoom in March. The board and faculty spent time discussing lessons learned during the pandemic and ideas for moving forward.

The board and program will soon begin planning for a face-to-face meet and greet with practitioners that will sync with the WASLA Conference in Spokane, in October.

The SDC Central Board and LA Board look forward to the prospect of meeting in person, in the fall.